

MOKULUA ISLANDS  
(Off limits)

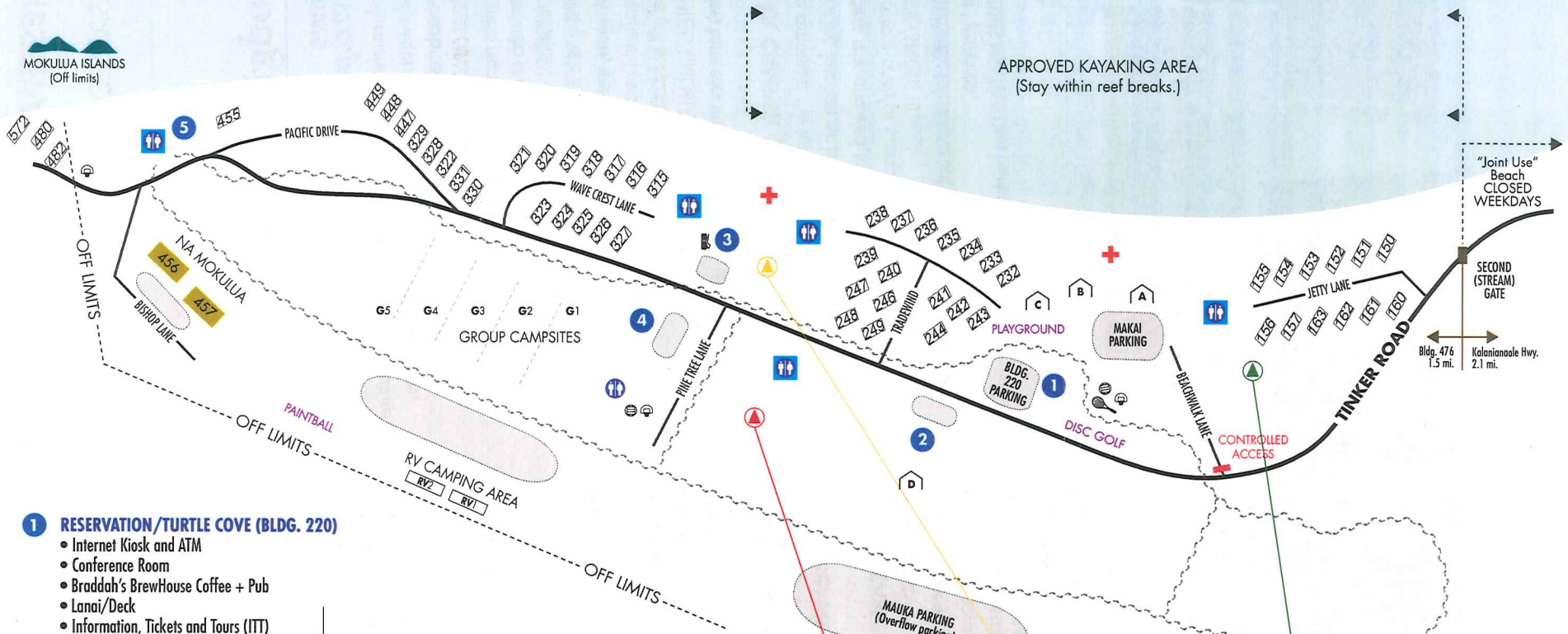

APPROVED KAYAKING AREA  
(Stay within reef breaks.)

"Joint Use" Beach  
CLOSED WEEKDAYS

SECOND (STREAM) GATE  
Bldg. 476 1.5 mi.  
Kalanianaʻole Hwy. 2.1 mi.

**1 RESERVATION/TURTLE COVE (BLDG. 220)**

- Internet Kiosk and ATM
- Conference Room
- Braddah's BrewHouse Coffee + Pub
- Lanai/Deck
- Information, Tickets and Tours (ITT)
- Outdoor Recreation Adventures
- Gear/Party/Sports Equipment Rentals
- Hale Nalu Massage
- Retail Store

**2 GOLF SHACK**

Miniature Golf and Driving Range

**3 AAFES EXPRESS**

Shoppette, Launderette, Gas Pump

**4 HEADQUARTERS BLDG. 515**

- Command Section
- Law Enforcement Desk
- Security Forces

**5 BLDG. 476**

- Lifeguard/Marketing Office

- Bathhouse
- Restroom
- Lifeguard Tower
- Pavilion
- Parking

**PARKING**

**MAKAI PARKING:** During elevated Force Protection Conditions: Limited to handicap, shuttle, drop off/pick up only.  
**MAUKA PARKING:** General, overflow parking. No parking on grass.  
**BLDG. 220 PARKING:** No parking, authorized vehicles only.

**BELLOWS LOOP TRAIL**

This three-mile loop connects the multi-use path and hiking trail. Closed after dark.

**NA MOKULUA**

**456**  
1st floor:  
N101 - N104  
2nd floor:  
N201 - N204

**457**  
1st floor:  
I105 - I108  
2nd floor:  
I205 - I208

**FAMILY CAMPSITE AND CEDAR CAMPER CABINS DETAIL**

**FAMILY CAMPSITE - LETTERED**

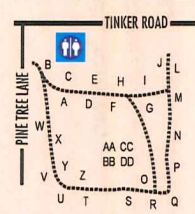

**FAMILY CAMPSITE - OCEANVIEW**



**FAMILY CAMPSITE - MENEHUNE CEDAR CAMPER CABINS**

